



Picture may vary from actual product

Lite.Gate 'DoorReader'



Door reader with many qualities.

With the high-quality people access reader, only authorized persons have access to certain areas. Especially high ease of use is given thanks to the versatile possibilities for the authorization check. The reader, with its recognizable SKIDATA design, is immediately noticeable. It also scores points with its low servicing requirements, full flexibility during installation, and the ability to connect external systems.

Variable authorization checking

The reader can read both the keycards from contract users, as well as crosswise barcodes and QR codes from e-tickets, for example from Smartphones for one-time users. An integrated touch screen also allows the input of access codes. If you would like to use other readers or keyboards, you can easily integrate these using an interface.

Designed for ease of operation

Not only do the versatile authorization options offer a high level of user friendliness. Thanks to the high-quality SKIDATA appearance of the reader, it is immediately noticeable and recognizable. And the design can do even more: It doesn't matter if it's hot, cold, stormy or dry - the access reader is extremely weather tolerant.

Installation according to your requirements

Mount the reader, where you need it. The fixability at the bottom means that it can be used at places where no wall mounting is possible. In addition, you can integrate the reader with external systems such as doors or rolling gates as needed.

Low service requirements

Save on the subsequent costs. Virtually maintenance-free components optimize your service and maintenance expenses. You offer your customers support over intercom at any time and at the touch of button, without much effort to you at all.

all dimensions in mm

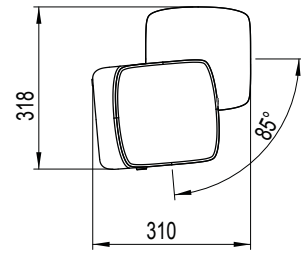
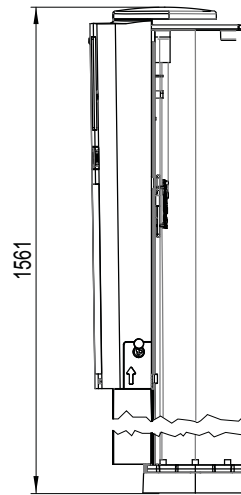
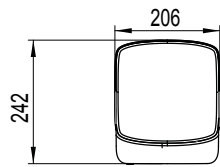
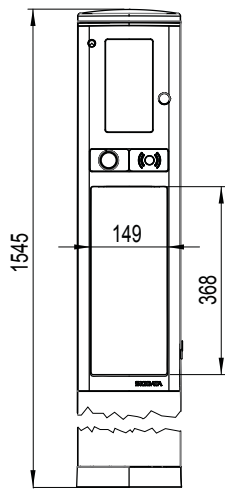

Features

Design/Construction

- Unique design based on aluminum and high-grade synthetics
- Modular construction, easy to maintain
- Flexible extension options ensure maximum investment protection
- Weather-proof, thanks to use of high-quality, durable materials, e.g. aluminum
- Ethernet interface for efficient system integration
- Large mounting bezel for flexible extension (e. g., credit card reader, etc.)

Operation

- Intuitive user interaction ensures smooth, trouble-free processing
- Visual and acoustic feedback provides additional user support

Green Efficiency

- Optimized for low power consumption; no heating required down to minus 20 °C (– 4 °F)
- Materials provide high degree of re-usability

Options

Design/Construction

- LED light bar serves as a stylish, illuminated eye-catcher
- Optional custom color design for device housing

Ticket Processing

- RFID module for reading and encoding 13 MHz keycards
- Print@Home scanner with special optical array for paper tickets and smartphones; supports various formats
- Support of 'classic' ticketing with insert reader for tickets with crosswise barcode

Communication

- Analog intercom
- Ethernet-based digital intercom
- Bi-directional video communication (including camera)

Display

- Basic status display for simple applications
- Bright high-resolution graphics display ensures good readability under any light conditions; supports clear, vivid display of commercials and videos (with automatic brightness adjustment); 800×480 pixels
- Outdoor capable touch screen for access code input (can be operated even when wearing gloves)
- Sophisticated display modes support various applications and design options

Accessories

- Locking system with mechanical or electronic locks for configurable access permissions
- Various contact and interface extensions to suit a wide range of requirements
- Heater and cooling fan for handling extreme ambient temperatures
- AFILS inductive hearing aid support for clear communication

Technical Specifications

Dimensions	206 mm × 1545 mm × 242 mm (W × H × D)
Weight	approx. 20 kg
Operating voltage	100-240 V ±10 % / 50-60 Hz
Operating temperature	–20 °C (–4 °F) to +50 °C (122 °F) in shade –20 °C (–4 °F) to +40 °C (104 °F) under sun exposure
Operating temperature with additional cooling	up to +50 °C (122 °F) under sun exposure
Operating temperature with additional heating	down to –40 °C
Max. ambient humidity	90 % (non-condensing)
Support stand color	Brushed aluminum, anodized
Cover of top section cover	RAL 7037 Dusty Grey (varnished plastic)
Panel color	RAL 7021 Black Grey (varnished plastic)
Guidelines / certifications	CE (incl. WEEE), FCC, IC, _C NRTL _{US}
Degree of protection based on IEC 60529	IP43
System requirements	Parking.Logic V09